

# MISSISSIPPI THEATRE ASSOCIATION 2022 FESTIVAL



**JANUARY 13-16, 2022**  
**MSU Riley Center Historic Theatre**  
**Meridian, Mississippi**

**#MTAISBACK**



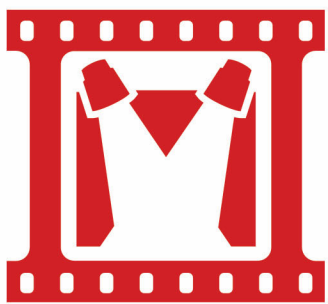

# **THEATRE & FILM**

AT

THE UNIVERSITY OF  
MISSISSIPPI

**BFA EMPHASES IN:**

**ACTING FOR  
STAGE & SCREEN  
DESIGN/THEATRE  
PRODUCTION**

**BFA IN FILM PRODUCTION**

AND

**BA IN THEATRE ARTS**



110 ISOM HALL, PO BOX 1848, UNIVERSITY, MS 38677 | (662) 915-5816 | [THEATREANDFILM.OLEMISS.EDU](http://THEATREANDFILM.OLEMISS.EDU)

# MISSISSIPPI THEATRE ASSOCIATION

# 2022 FESTIVAL

Hosted by  
**THE MSU RILEY CENTER**  
**JANUARY 13-16, 2022**  
**MERIDIAN, MISSISSIPPI**

**FESTIVAL COORDINATOR**.....Michele Thames  
**TECHNICAL DIRECTOR** ..... Andy Rainey  
**EVENT COORDINATORS**.....Ron Johnigan and Serena Sanders  
**PROGRAM** ..... Pattye Archer  
**PHOTOGRAPHER**..... Sydnee Tapley  
**ASSISTANT FESTIVAL COORDINATOR** ..... Sawyer Walters

## MTA Dream Team

Reese Overstreet  
Aysha Celestin  
Vidur Katyal  
Kat Goss

Harley Armstrong  
Izzy Christensen  
Kayla Jacobs

## SPECIAL THANKS

Please help us in expressing our gratitude to our hosts and festival coordinators for their hard work in organizing and preparing for this festival.

This festival would not be possible without the countless hours of work by the host theatre. Very special thanks to all of the volunteers!

The MSU Riley Center

## OTHER SPECIAL THANKS

Chris Bailey  
John Barnts  
Certifiable Studios  
Shelby Crosby  
Dogmud Tavern  
Olivia Dunwoody  
Debbie Dunaway

Lindsey Eubanks  
Sarah Grammar  
Anquanizia Hall  
Tom Hardy  
Mississippi Aquarium  
Esther Newell  
Ohr O'Keefe Museum

Lauren Ray  
Think Webstore  
Visit Meridian  
William Carey University  
Representative Hank Zuber



# MISSISSIPPI THEATRE ASSOCIATION

# OFFICERS and BOARD

## OFFICERS

Executive Director .....	Stacy Howell
President.....	Juniper Wallace
Vice-President.....	Gabe Smith
Past-President.....	Tim Matheny
Treasurer .....	Stephanie Chance
Secretary.....	Bronwyn Teague

## BOARD OF DIRECTORS

10-Minute Festival Chair .....	Elizabeth Thomas-Hines
10-Minute Festival Vice-Chairs.....	Randy Ferino and Carrie Ferguson - Bellew
College & University Theatre Chair .....	Tim Matheny
College & University Theatre Vice-Chair .....	Alison Stafford
Community Theatre Chair .....	Bobby Geno
Mississippi State Auditions Coordinator .....	Elissa Sartwell
Mississippi State Auditions Vice-Coordinator .....	Tim Matheny
Playwriting Division Chair (Adult).....	Boyce Deaton
Playwriting Division Chair (Youth).....	Tonya Hays
Secondary Theatre Chair .....	Suz Allmon
Secondary Theatre Vice-Chairs .....	Kerri Sanders and Chris Permenter
Theatre for Youth Chair.....	Ruthie Taylor
Theatre for Youth Vice-Chair .....	Keri Horn
Individual Events Chair (Youth).....	Sarah Hankins
Individual Events Vice Chairs (Youth).....	Jessica Wilkinson and Lauren Ray
Individual Events Chair (Adult).....	Amy Smith
Professional Division .....	Francine Reynolds
SETC Representative .....	Kathy Newman

## FESTIVAL SPONSORS

The Mississippi Theatre Association greatly acknowledges our sponsors.  
Without their support this festival would not be possible!

Mississippi Arts Commission  
National Endowment for the Arts  
William Carey University  
Our Group Tour  
Davaine Lighting



mississippi arts commission







# HALFWAY BETWEEN HERE AND THERE

...lives a city reinventing itself with one-of-a-kind museums, historic theaters, fine dining, craft brews, and a new boutique hotel, all right downtown. Come visit this city on the move. Just off I-59/20 and way beyond your expectations.

— VISIT —  
**MERIDIAN**  
MISSISSIPPI

[VisitMeridian.com](http://VisitMeridian.com)

Dallas, TX 493 MI

Meridian, MS

Nashville, TN 335 MI

New Orleans, LA 198 MI

Atlanta, GA 290 MI



# FROM *the* PRESIDENT

If the past year has reminded us of anything, it is that theatre-makers have always and will always persevere. Although this year has been far from “back to normal,” we continue to find new ways to meet the challenges that we face. Our determination is the thing to celebrate this weekend. Congratulations for continuing to find ways to bring theatre to life. This weekend, we celebrate you!



A festival of this magnitude requires a great deal of planning and cooperation; so many people deserve our gratitude! First, thanks to Michelle Thames and the MSU Riley Center staff for working with us to ensure the success of this event. This is our third festival at the Riley Center, and it is always an immense pleasure to have the opportunity to work in this beautiful space. Next, we are thrilled and grateful to have a full Dream Team with us this year. The Dream Team consists of collegiate theatre-maker volunteers who are integral in helping ensure that each part of the festival runs smoothly.

Speaking of running smoothly, this festival cannot happen without the support of our Executive Committee and Board of Directors. Our divisions have worked throughout the year to plan this festival weekend and to continue the outreach and advocacy that are so important to the mission of the Mississippi Theatre Association. Divisions have also received feedback from our members and made adjustments to better accommodate your needs. We are so grateful for the volunteers who comprise our Board of Directors.

Next, I'd like to recognize the tireless efforts of Past President, Tim Matheny. Tim continues to be a compassionate advisor who is always willing to step in and help. Finally, MTA would not continue to flourish without the leadership of our executive director, Stacy Howell. She puts in countless hours throughout the year for the betterment of MTA. Thank you, Stacy, for your focus, friendship, and support.

And, of course, thank you to YOU - to everyone involved this weekend and throughout the calendar year for your dedication and commitment to MTA!

Last year we pined for days when we could gather to experience art together. This year, that wish is a reality once more! In spite of the challenges, we celebrate the art that brings us together.

As I enter my final year of my term as President, I continue to look forward to the incredible art that will come out of these times. Thank you for joining us this weekend, thank you for making your theatrical mark on our state, and thank you for the determination that demonstrates yet again that MISSISSIPPI DOES GREAT THEATRE!

*Juniper Wallace*  
President

## MTA OVERALL GOALS

- Acting as an advocate to government agencies, businesses and the public.
- Sponsoring festivals, workshops, and networking opportunities.
- Communicating with members and the public.
- Recognizing excellence in performance and production.
- Sanctioning representatives to regional festivals.



# Remembering and celebrating Dr. Martin Luther King, Jr.

The Mississippi Theatre Association would like to acknowledge Dr. Martin Luther King, Jr.'s birthday this Saturday, January 15. We celebrate the life and achievements of the influential civil rights leader annually on the third Monday of January - MLK Jr. Day, a federal holiday. Dr. King diligently worked to end racial segregation on public transportation, in public schools and workplaces, calling for racial equality on a national level. Dr. King took tremendous strides to advance civil liberties for African Americans. Although we celebrate him and those life changing strides, let us make the holiday more than just a day off and take time to reflect and take action on civil rights issues across the globe.

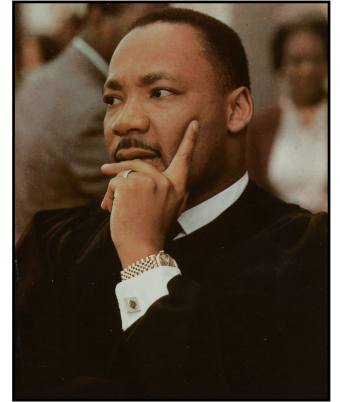

## Land Acknowledgment

The Mississippi Theatre Association recognizes and acknowledges we are currently in Meridian, Mississippi which was originally the land of indigenous Choctaw people. We honor the land and the people, and we acknowledge that we benefit from their tragic loss of land through colonialism, genocide, and systematic attacks. We honor and respect the indigenous people connected to this land with gratitude.



**WILLIAM CAREY**  
UNIVERSITY

## Department of Theatre & Communication

### BFA

- Scriptwriting (*Available fully online*)
- Theatre for Young Audiences

### BA in Theatre *Concentrations*

- Musical Theatre
- Performance
- Design

[www.wmcarey.edu](http://www.wmcarey.edu)





# SCHEDULE of EVENTS

**THURSDAY, JANUARY 13, 2022**

- 1:30 P.M.**      **Festival Registration Opens**  
Location: MSU Riley Center, Grand Lobby  
Send one Teacher / Director representative to register students from each school.
- 2:00 P.M.**      **High School Directors Meeting (Mandatory)**  
Location: MSU Riley Historic Theatre
- 4:30 P.M.**      **Festival Registration Closes**
- 5:00 P.M.**      **High School Senior and Junior Auditions Registration and Setup**  
(Pre-Registration Required. Please send one representative per school to register.)  
Location: MSU Riley Center - 2nd Floor Elevator Lobby
- 6:00 P.M.**      **Tech Auditions Begin** (Closed auditions)  
Location: MSU Riley Historic Theatre
- 7:00 P.M.**      **Actor Auditions Begin** (Closed auditions)  
Location: MSU Riley Historic Theatre
- 7:00 P.M.**      **Workshops**  
Please see page 17 for a complete listing of workshop descriptions and locations.
- 9:15 P.M.**      **College & University Division Meeting**  
Location: Threefoot Building Boardroom  
601 22nd Avenue, Meridian

Note: Meeting will start after the conclusion of auditions / talk back / tech reviews.



**Mission:** To foster appreciation and participation in theatre.

**Vision Statement:** A Mississippi where art is valued through the power of theatre.

**Values: ACE**

- **Advocate** - To publicly support or recommend a particular cause or policy.
- **Communicate** - Share or exchange information, news, or ideas.
- **Educate** - To train by formal instruction, and supervised practice especially in a trade, skill, or profession.

BREAK A LEG!

ST. MARTIN THEATRE

*Brian The Comet*

by Emily Hageman

Friday, January 14th @ 8pm

Ally

Vincent

Blake

Leanne

Maya

Annie S.

Angelique

Mabel

Crystal

Madison

Yuriho

Miles

Indiana

Courtney

Sophie

Dell

Johnathan

Hannah

Riley

Tori

# SCHEDULE of EVENTS

## FRIDAY, JANUARY 14, 2022

**7:00 A.M.**      **Registration Opens**  
Location: MSU Riley Center, Grand Lobby

**8:00 A.M.**      **Teachers Receiving CEUs Meeting**  
Location: MSU Riley Center, Boardroom 3A

**8:00 A.M.**      **WELCOME**  
Location: The MSU Riley Center Historic Theatre

**8:30 A.M.**      **SECONDARY PERFORMANCE BLOCK I**  
Location: MSU Riley Historic Theatre

**MERIDIAN HIGH SCHOOL PERFORMANCE**  
*Decoration Day (The Annihilation of Black Wall Street)*

By Randy Ferino

Produced by Arrangement with Randy Ferino

Directed by Randy Ferino

Disclaimer: Mature Content, Adult      ★ Contains mature content, gunshots, and more  
Language, Firearms or Weapons,

Gunshots / Loud Noises, Fog / Haze Effects, Lighting Effects

**OXFORD HIGH SCHOOL PERFORMANCE**  
*Strangers on a Train*

By Craig Warner

Produced by Arrangement with 42 Palladium House London

Directed by John Davenport

Disclaimer: Mature Content,      ★ Contains mature content, gunshots, and more

Gunshots / Loud Noises, Fog / Haze Effects

**JACKSON PREP HIGH SCHOOL PERFORMANCE**  
*The Miraculous Journey of Edward Tulane*

By Dwayne Hartford

Produced by Arrangement with Dramatic Publishing

Directed by Emily Waterloo

**11:45 P.M.**      **Lunch Break**  
Boxed lunches can be picked up outside of the Exhibit Hall.

**12:30 P.M.**      **WORKSHOPS**  
Please see pages 18 and 19 for a complete listing of workshop descriptions and locations.

**2:00 P.M.**      **Call to be Seated**





# SCHEDULE of EVENTS

**FRIDAY, JANUARY 14, 2022 (continued)**

**2:10 P.M.**

## **SECONDARY PERFORMANCE BLOCK II**

Location: MSU Riley Historic Theatre

### **OAK GROVE HIGH SCHOOL PERFORMANCE**

#### ***The Old Man and the Old Moon***

By Pigpen Theatre Co.

Produced by Arrangement with Playscripts, Inc.

Directed by Suzanne Allmon

Disclaimer: Fog / Haze Effects, and

Lighting Effects

★ Contains fog / haze and lighting effects

### **ST. PATRICK CATHOLIC HIGH SCHOOL PERFORMANCE**

#### ***Check Please***

By Jonathan Rand

Produced by Arrangement with Playscripts, Inc.

Directed by Jay Lynn

### **NORTHWEST RANKIN HIGH SCHOOL PERFORMANCE**

#### ***Icarus***

By Jessica Chipman

Produced by Arrangement with Eldridge Plays and Musicals

Directed by Juniper Wallace

**5:30 P.M.**

**Dinner Break**

**7:05 P.M.**

**Call to be Seated**

**7:15 P.M.**

## **SECONDARY PERFORMANCE BLOCK III**

Location: MSU Riley Historic Theatre

### **STONE HIGH SCHOOL PERFORMANCE**

#### ***I and You***

By Lauren Gunderson

Produced by Arrangement with Playscripts, Inc.

Directed by Jordan West

### **ST. MARTIN HIGH SCHOOL PERFORMANCE**

#### ***Brian the Comet***

By Emily Hagerman

Produced by Arrangement with Stage Partners

Directed by Sarah Bartos

Disclaimer: Mature Content

★ Mature content

**8:00 P.M.**

**Adult Individual Events Festival**

Location: MSU Riley Center, Studio Theatre

# SCHEDULE of EVENTS

**SATURDAY, JANUARY 15, 2022**

- 7:00 A.M.**      **Registration Opens**  
Location: MSU Riley Center, Grand Lobby
- 7:15 A.M.**      **Youth Individual Events Team Check-In** (Teacher Representative for each school)  
Location: MSU Riley Center, Board Room 4A
- 8:00 A.M.**      **Youth Individual Events Begins**  
Location: MSU Riley Center
- 8:30 A.M.**      **WORKSHOPS**  
Please see page 20 for a complete listing of workshop descriptions and locations.
- 10:00 A.M.**      **WORKSHOPS**  
Please see page 21 for a complete listing of workshop descriptions and locations.
- 11:00 A.M.**      **COMMUNITY THEATRE SHOWCASE**  
Location: MSU Riley Historic Theatre

## **TUPELO COMMUNITY THEATRE**

### ***The Seafarer***

By Conor McPherson

Produced by Arrangement with Dramatists Play Service

Directed by Tom Booth

Disclaimer: Mature Language

★ Mature Language

- 12:00 P.M.**      **Lunch Break**  
Boxed lunches can be picked up outside of the Exhibit Hall.
- 1:00 P.M.**      **WORKSHOPS**  
Please see pages 22 and 23 for a complete listing of workshop descriptions and locations.
- 1:00 P.M.**      **Secondary Division Meeting**  
Location: Meeting Room 4A
- 1:00 P.M.**      **STAGED READING OF PLAYWRITING COMPETITION WINNING PLAYS**  
Location: MSU Riley Center, Studio Theatre

Adult Production, 1st Place Winner: *Drinks on Me*

By Prince Duren, Jackson State University

Disclaimer: Mature Language

★ Mature Language

---

To keep up with MTA 2022 Festival information and changes, like us on Facebook.  
Make sure to turn on your notifications to insure timely information.

Wireless password is **dynamic**.



# SCHEDULE of EVENTS

**SATURDAY, JANUARY 15, 2022 (continued)**

**2:00 P.M.**

**WORKSHOPS**

Please see page 24 for a complete listing of workshop descriptions and locations.

**2:00 P.M.**

**STAGED READING OF PLAYWRITING COMPETITION WINNING PLAYS  
SPONSORED BY WILLIAM CAREY UNIVERSITY**

Location: MSU Riley Center, Studio Theatre

Youth Production, 1st Place Winner: *January 24, 1971*  
By Sydney Knotts, Mississippi School of the Arts  
Presented by Harrison Central High School

**3:00 P.M.**

**COMMUNITY THEATRE FORUM**

Location: MSU Riley Center, Boardroom 3A

Please see page 24 for complete details.



## A TRADITION *of* EXCELLENCE

Jackson Academy brings new meaning to excellence in arts with our first-class productions, award winning show choirs, superior concert, jazz, and marching bands, Gold Key art winners, and expansive Performing Arts Center. JA provides meaningful opportunities for K3-12th grade students to discover and nurture their artistic potential, all within a vibrantly creative community.

JACKSON **JA** ACADEMY

Call **601.362.9676** or go to **VisitJA.org** to schedule your tour today!

**#MTAISBACK**



# SCHEDULE of EVENTS

**SATURDAY, JANUARY 15, 2022** (continued)

**3:00 P.M.**

## **THEATRE FOR YOUTH FESTIVAL**

Location: MSU Riley Historic Theatre

### **PERFORMANCES**

#### **PURVIS HIGH SCHOOL**

##### ***The Adventures of Mouse Deer***

By Aaron Shepard

Public Domain

Directed by Dana Jones

Appropriate for Ages: 3rd - 5th Grade

#### **NORTHWEST RANKIN HIGH SCHOOL**

##### ***Monster Camp: A Tale of Monsters, Misunderstandings, and Marshmallows***

By Riley Tuccio, Makyla Fleming, and Whitney Southam

Original Production

Directed by Lauren Ray

Appropriate for Ages: K - 6th Grade

#### **OAK GROVE HIGH SCHOOL**

##### ***Jungle Book***

By April-Dawn Gladu

Produced by Arrangement with Theatre for Young Audiences

Directed by Suzanne Allmon

Appropriate for Ages: K - 3rd Grade

#### **STONE HIGH SCHOOL**

##### ***Wild Island Adventure***

By Claudia Haas

Produced by Arrangement with Eldridge Plays and Musicals

Directed by Jordan West

Appropriate for Ages: K - 5th Grade

**4:50 P.M.**

**Break**

**5:10 P.M.**

### **PERFORMANCES**

#### **OCEAN SPRINGS HIGH SCHOOL**

##### ***Alice: A Vaudeville Adaptation of "Alice Adventures in Wonderland"***

by Lewis Carroll

Written by Malayna Knapp, Devin Carter, Jay Taylor,

Paola Santiago Rodriguez, and Averie Niolet

Original Production

Directed by Chris Permenter

Appropriate for Ages: K - 6th Grade

# SCHEDULE of EVENTS

**SATURDAY, JANUARY 15, 2022** (continued)

**CLINTON HIGH SCHOOL**

***Sleeping Beauty***

By Stacy Lane

Produced by Arrangement with Playscripts, Inc.

Directed by Sarah Hankins

Appropriate for Ages: K - 6th grade

**7:00 P.M.**

**Break**

**8:00 P.M.**

**YOUTH SOCIAL**

Location: MSU Riley Center, Exhibit Hall and Studio Theatre

**8:00 P.M.**

**ADULT SOCIAL**

Location: Weidman's

Downstairs bar

210 22nd Avenue

## **SUNDAY, JANUARY 16, 2022**

**9:30 A.M.**

**CEU Meeting**

Location: Meeting Room 2A

**10:00 A.M.**

**MTA BUSINESS MEETING AND AWARDS CEREMONY**

MSU Riley Historic Theatre (will be broadcast on FB Live)

# Youth Social

High School students are invited to attend this year's Youth Social

at MSU Riley Center Exhibit Hall and Studio Theatre at **8:00 pm on Saturday, January 15**. After a long day at the festival, students are invited to join us for a fun and relaxing evening of movies, board games, theatre games, and more! Students will have the opportunity to make new friends from other schools as they spend time bonding over some of their favorite board games and improv games! Be sure to bring your A-game! Pizza will be provided.



# INDIVIDUAL EVENTS

**SATURDAY, JANUARY 15, 2022**

Location: The MSU Riley Center

This schedule is tentative and is subject to change. (End times are approximate.)

Competition Rooms – Meeting Rooms 2A, 2-B/C, 2D, 3D

Hospitality Room – Meeting Room 3A

Tabulation Room – Meeting Room 4A

- Students are asked to remain quiet in the hallways and outside of rooms.
- Students are encouraged to watch finals but must be polite audience members.
- Doors will be opened after each 5th performance to allow participants to quickly enter/exit the room.
- If a student breaks to more than one final round, he/she should report his/her first event and then report to his/her second event.

**7:15 A.M. Meeting for Directors of Students Participating in Final IEs and Technical IEs**  
Location: Meeting Room 4A (Tabulation Room)

**7:30-8:00 A.M. Technical Design Students – Set up displays**  
Location: Exhibit Hall

**7:30 A.M. Judges Report**  
Location: Meeting Room 3A (Hospitality Room)

**7:30-7:55 A.M. Event Rooms Open for Seating** (Doors will close at 7:55 a.m.)

**8:00 A.M. Flight 1 and Technical IEs Judging Begins**

***Acting Female/Male***  
Location: Meeting Room 2A

***Acting & Musical Duets***  
Location: Meeting Room 2B/C

***Musical Female/Male***  
Location: Meeting Room 3C

Flight 1 - 8:00-8:25

Flight 2 - 8:30-8:55

Flight 3 - 9:00-9:25

**Break - 9:25-9:45**

Flight 4 - 9:45-10:10

Flight 5 - 10:15-10:40

Flight 6 - 10:45-11:10

*Acting*

Flight 1 - 8:00-8:35

Flight 2 - 8:40-9:15

Flight 3 - 9:20-9:55

*Musical*

Flight 1 - 10:15-10:50

Flight 2 - 10:55-11:30

Flight 3 - 11:35-12:10

Flight 1 - 8:00-8:35

Flight 2 - 8:40-9:15

Flight 3 - 9:20-9:55

**Break - 9:55-10:15**

Flight 4 - 10:15-10:50

Flight 5 - 10:55-11:30

Flight 6 - 11:35-12:10

***Acting Group***

Location: Meeting Room 2D

Flight 1 - 8:00-8:35

Flight 2 - 8:40-9:15



# WORKSHOPS

THURSDAY, JANUARY 13, 2022, 7:00-7:50 P.M. AND 8:00-8:50 P.M.

**Actor's Nightmare- De-Mystifying Rep Selection** (workshop will be offered at both times)

Location: MSU Riley Center, Studio Theatre  
Crystal Marie Stewart, MTA Adjudicator

We've all been there- we have an audition coming up, and we need new material for it, but we don't know where to start- so we ask friends, who give us a list of plays. But we're looking through them, and we CAN'T FIND ANYTHING, and we feel like we've wasted the day.

This workshop will have tips and tricks for finding good monologues for auditions (because you're not wrong, it's kind of a trap), and for finding things that will work for your energy, the situation, and are just plain \*engaging.\*

**Awake the Centers, Broaden the Qualities, Sharpen the Physical Character**

(workshop will be offered at both times)

Location: MSU Riley Center, Exhibit Hall

Lee Crouse, SETC Educational Services & Sponsorships Manager

You understand the given circumstances, you've nailed the lines. Now to create a living, breathing, physical character. Explore and play with Michael Chekhov's Centers and Qualities of Movement as a route to create physical character and action! Come ready to move.



## NEWSTAGEED

TOURING:

***The Debate for Democracy***

**Themes: Martin Luther King Jr, Ella Baker, Fannie Lou Hamer,  
Civil Rights, Mississippi Democratic Freedom Party**

Available for touring in January and February 2022

**For more info: [www.newstagetheatre.com](http://www.newstagetheatre.com)**

**601-948-3533**

**SCHOOLFEST MATINEES: \$8/PERSON Ages 13+**

***I Just Stopped By to See the Man*** by Stephen Jeffreys

February 3 & 10, 2022 at 10 a.m.

***The Curious Incident of the Dog in the Night Time*** by Simon Stephens

March 30, April 1, 5 & 7, 2022 at 10 .m.

# WORKSHOPS

**FRIDAY, JANUARY 14, 2022, 12:30-1:30 P.M.**

## **Awake the Centers, Broaden the Qualities, Sharpen the Physical Character**

Location: MSU Riley Center, Exhibit Hall

Lee Crouse, SETC Educational Services & Sponsorships Manager

You understand the given circumstances, you've nailed the lines. Now to create a living, breathing, physical character. Explore and play with Michael Chekhov's Centers and Qualities of Movement as a route to create physical character and action! Come ready to move.

## **Creating Senior Readers Theatre**

Location: Studio Theatre

Sherri Marengo, L.A.T.E.

Legacy Actors Theatre Experience is the first Senior Readers Theatre group in the state, and these very active adults would love to share their experiences. Founder Sherri Marengo has the guidebook for recruiting, training and enjoying the twilight years in a safe and fun way!

## **Improv Games**

Location: Meeting Room 4C

Kenneth McDade, Canton Christian Academy

The objectives of this workshop are to discover the fundamentals of improvisational comedy, improve your storytelling skills, learn techniques to think quickly on your feet and be more creative. This spirited, fun course is designed for the actor or performer who wants to learn the essentials of good scenic improvisation or anyone who wants to improve their teamwork or communication skills. This class not only teaches you how but teaches you the "why" you are playing the game. Yes, it is fun, but does it have a purpose? We discover the reasons behind the games. Through coaching, warm-up exercises, creative performance games, and basic short-form scene-work, you will learn how to be more spontaneous, trusting, and cooperative and how to listen in a fun, creative atmosphere. This class is open to new and continuing students of all ages and experiences.

## **Mississippi Theatre Standards**

Location: Meeting Room 2D

Limeul Eubanks, Mississippi Department of Education

Join us for a discussion on understanding the four artistic processes and how we can meaningfully integrate the *Mississippi College- and Career-Readiness Arts Learning Standards for Theatre* into our theatre practices.

*525,600 minutes...* How do you measure a year in a life?



# WORKSHOPS

FRIDAY, JANUARY 14, 2022, 12:30-1:30 P.M. (CONTINUED)

## Monologue Workshop

Location: Meeting Room 3C

Anquanizia "Tia" Hall

Are you looking for a new way to approach your favorite monologue? Do you need help taking your monologue to another level? This workshop will not only help you discover a fresh take of your monologue, but will also teach you acting foundations. Have a monologue prepared to perform (off book). Let's play!

## The Art of The Audition

Location: Meeting Room 2A

Francine Thomas Reynolds

Being a good actor and having a good audition technique are two different things. The Art of the Audition is specifically designed to analyze the technique directors are looking for in the casting process. The workshop will break down the types of auditions directors and actors experience, offer tips for text analysis and teach actors how to clarify the specifics while making authentic acting choices. The workshop involves discussion and demonstrations detailing how actors should prepare for specified script and cold readings. The workshop will also cover how to prepare monologues for school auditions.

Can your organization improve with improv?

# THE ROYAL Y'ALL

**YES! And...**

**The Royal Y'all Improv Team can show you how!**

Our highly interactive workshop uses the **Power of Improv** to help your team build trust, creatively solve problems, and communicate effectively.

**We also bring a lot of fun and laughter!**



If you'd like us to perform or teach at your next conference, reunion, or gathering, contact us:

 [RoyalYallimprov@gmail.com](mailto:RoyalYallimprov@gmail.com)  [@TheRoyalYallIMS](https://www.facebook.com/TheRoyalYallIMS)  [@RoyalYallimprov](https://www.instagram.com/RoyalYallimprov)



# WORKSHOPS

SATURDAY, JANUARY 15, 2022

8:30 A.M. –12:00 P.M.

## Take a Hero's Journey

Location: Meeting Room 4B

Elliott Street and Jeremy Sande, Angels Theatre

“Take a Hero's Journey” is adaptable as a primer or as an advanced workshop for students, writers and/or teachers who want to learn the essentials of telling a visual story. Using the established archetypes of J. Campbell, the structuring of C. Vogler, Street breaks down the Acts of a Story into understandable techniques for story-boarding for film. It is possible to create a film / video movie in five hours. This PBL / SBL workshop was developed using the Achieve Mississippi principals.



Whether you are a professional or an emerging artist, we are here to help you grow your career and connect you with the industry! Join us!

Professional Auditions | Collegiate Auditions & Interviews  
Theatre Job Fair | 250+ Workshops | OSHA Training  
Teachers Institute | EDIA Series | Focused Networking  
Fringe Festival | Industry-leading Keynote Speakers  
Events | Commercial & Educational Exhibit Hall  
Design Competition | Interest Groups | Awards  
Secondary School Festival | Community Theatre Festival  
Theatre for Youth Invitational | Ten-Minute Play Festival

Register Now at [convention.setc.org](http://convention.setc.org)  
Early-Bird Rate Deadline: January 20, 2022  
Regular Rate Deadline: February 25, 2022

Connecting You to Opportunities in Theatre Nationwide!



**aact**  
AMERICAN ASSOCIATION  
OF COMMUNITY THEATRE  
*Helping Theatres Thrive*



*In the Heights*  
South Bend Civic Theatre, South Bend, Indiana

AACT is the place to go for connections to resources and tools that you need to create theatre  
*Introductory rates for first time members*

**JOIN NOW!**

**aact.org**

**AACT NewPlayFest**  
[aact.org/newplayfest](http://aact.org/newplayfest)

**Community Theatre  
Management  
Conference**

East Coast Session:  
VIRTUAL March 4-6, 2022  
West Coast Session:  
VIRTUAL March 18-20, 2022  
[aact.org/ctmc](http://aact.org/ctmc)

**aactWORLDFFEST 2022**  
June 20-26, Venice, FL  
[aact.org/worldfest](http://aact.org/worldfest)

**TEAMS Conference**  
July 29-31, 2022  
[aact.org/teams](http://aact.org/teams)

There **WILL BE** drama

(and singing and dancing and applause and jazz hands ...)

# WORKSHOPS

SATURDAY, JANUARY 15, 2022

10:00–11:00 A.M.

## **Improving Your Productions with Better Voice and Articulation** (for teachers and students)

Location: Meeting Room 3B

Paula Mabry, Starkville Community Theatre

1. Introduction to the benefits of good voice and articulation 2. Vocal and physical exercises for participants 3. Handouts for participants

## **Who's Afraid of the Big Bad Bard**

Location: Meeting Room 3D

Amile Wilson, Mississippi Shakespeare Festival

A hands-on, performance-driven approach to bringing Shakespeare to life! We'll break down the poetry (and prose) to help you build your classical performing muscles!

## **Arts Integration: An Overview and Active Reflection**

Location: Meeting Room 4C

Heather LaCoste, Ed.D.; Mississippi Alliance for Arts Education

Join us for an overview of the benefits of arts integration within the classroom setting. Learn how arts-integrated courses in pre-kindergarten through eighth grade increase equity in and access to the arts and may even help to prepare students to participate in theatre programs in middle school and high school. Allow this workshop to help you reconsider your role within your community as an arts advocate and leader.

MTA needs to pre-sell 300 before production can begin.  
*Help us make that happen!*

(For questions see us in the lobby.)



Click on the QR code to purchase your MTA license plate today!



# WORKSHOPS

**SATURDAY, JANUARY 15, 2022**

**1:00 –2:00 P.M.**

## **Intro to Projection Design**

Location: Meeting Room 2D  
Cody Stockstill, The University of Mississippi

A quick and easy introduction to Projection Design for theatre. Learn tips and tricks on how to turn any 2D image into an immersive projection. In this workshop we will cover how to create and prep your images in Photoshop, loading them into QLab, and how to set up surfaces in QLab for projection mapping.

## **Script Analysis That Helps**

Location: Meeting Room 3D  
Amile Wilson, Mississippi Shakespeare Festival

This crash-course gives everyone an exciting array of tools to help dive in and understand a script for better performance and production. Especially those old scripts!

## **Enhancing Storytelling Through Costuming**

Location: Meeting Room 2B/C  
Kaleigh Graham, Mississippi Repertory Theatre

This workshop breaks down how smaller details in costuming can enhance overall storytelling. Learn techniques that work no matter what your budget!

## **Enhancing Your Musical Theatre Audition**

Location: Classroom 3C  
Christie Rotarius, The University of Mississippi

In this workshop, you will work on enhancing your musical theatre audition through acting. In large part based on William Wesbrook's *Dramatic Circumstances: On Acting, Singing, and Living Inside the Stories We Tell*, Christie will guide a small number of participants through questions or simple exercises allowing singers to connect their vocal technique with their storytelling. Some things you might explore: the circumstances of your character, establishing a connection with your "other," going after an objective, using physical gesture rooted in the emotional life of the character, and listening for musical cues that suggest emotional choices you might make. Observers will be given opportunities to ask questions and draw conclusions based on their observations. A handout will be provided to help you take what you've learned with you and put it into practice outside the workshop.

## **Technology as an Integrated Art**

Location: Meeting Room 2A  
Jason Patrick Hudson, Mississippi Repertory

Do you want to work with modern technology to create immersive costumes and props? We will discuss the use of lighting and electrical technology as an integrated art in scenic pieces, costumes, and props. Topics will include LED technology, wireless dimming, portable atmospherics, open-source chipset programming, Show Control Technology, and common automation standards. Find out what designers around the country are doing to bring the newest and coolest technologies to the stage and wow audiences every night! Don't worry! We will keep it simple and there will be plenty of time for questions during the workshop.



# WORKSHOPS

**SATURDAY, JANUARY 15, 2022**

**1:00 –2:00 P.M. (CONTINUED)**

**Theatre Festival Survival**

Location: Meeting Room 4C

Tom Booth, Tupelo Community Theatre

How to endure and succeed at state, regional and national competitions. The ins and outs, what works and what doesn't from almost 30 years of participation as an actor and director. What can you take away from the process when all does not go as planned?



**MASKS ARE REQUIRED IN  
ALL INDOOR SPACES, EXCEPT  
WHEN ONSTAGE COMPETING.**

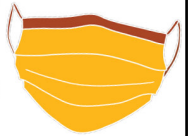

Best Wishes  
and Broken  
Legs!

LONG BEACH HIGH  
SCHOOL

# WORKSHOPS

**SATURDAY, JANUARY 15, 2022**

**2:00 –3:00 P.M.**

## **Makeup Tips, Tricks, and Emergency Kits!**

Location: Meeting Room 2B/C

Amber West, KCACTF Alcone Makeup Region 4 Winner and former MAC Artist

What do I need for a makeup emergency? How can I afford makeup needs on a budget? How do I stop pink eye from spreading to the entire cast?! All of these questions and more will be answered in this workshop!

**2:00 –5:00 P.M.**

## **Community Theatre Forum**

Location: Meeting Room 3A

Robert Geno, MTA

Join the Community Theatre Forums from around the state for an afternoon of networking and education. Introductions to the Mississippi Theatre Association, the Southeastern Theatre Conference, the American Association of Community Theatres, and AACT's Worldfest will be had. Wayne Andrews with the Mississippi Presenters Network will lead the group through a session of how to have our theatres act as a Business. Anquanizia "Tia" Hall will lead the group through a discussion of Equity, Diversity, and Inclusion in theatres. Grant opportunities with the Mississippi Arts Commission will be discussed. MTA will also have a division meeting at this time in an effort to evaluate how MTA can best be a resource to theatres around the state.

**3:00 –6:00 P.M.**

## **10-Minute Play Workshop**

Location: Exhibit Hall and Studio Theatre

10 Minute Vice Chairs, Carrie Ferguson - Bellew and Randy Ferino.

Join MTA for an introduction to the 10-Minute Festivals which are now held regionally across the state each fall. This workshop will lead students through the process of the creation and presentation of original scenes. Join us for this 3-hour workshop and network and play with others from across the state!

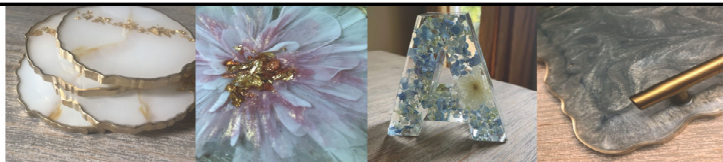

**ANGIE ADAIR  
DESIGNS**

Resin Art  
Unique Handmade Home Decor  
Custom Orders Welcome

[www.etsy.com/shop/AngieAdairDesignsCo](http://www.etsy.com/shop/AngieAdairDesignsCo)  
[angieadairdesigns@gmail.com](mailto:angieadairdesigns@gmail.com) Instagram - @angie\_adair\_designs

**— VISIT —  
MERIDIAN**



Tupelo Community Theatre  
presents



THE  
SEAFARER

By **Conor McPherson**

Directed by **Tom Booth**

TCT is happy to be back participating in MTA & SETC!  
Broken legs to all our theatre friends in Mississippi.  
Come see **The Seafarer** at 11 a.m. on Saturday.

**Note:** Play contains language some patrons may find offensive



# ADJUDICATORS

## SECONDARY DIVISION

### Crystal Marie Stewart

Crystal Marie Stewart is the Artistic Associate of Riverside Theatre, an equity theatre in Iowa City, IA. She is the National New Play Network Producer in Residence for 2020-2021 and has a Master of Fine Arts in acting, from The University of Iowa. Stewart has been working as a professional actor for 10 years.



Crystal Marie Stewart

### Kristy Meanor

Kristy Meanor has spent a lifetime in community theatre as an actor, director designer and producer. For the last 15 years she has served as the Artistic Director for the Wetumpka Depot Players. Serving in leadership roles with Southeastern Theatre Conference, she is also the past president of the Alabama Conference of Theatre and American Association of Community Theatre board member. Kristy is a recipient of the Marian Galloway Award for her contributions to theatre in Alabama. Performance credits include “Jessie” in *night Mother*, “Sister Amnesia” in *Nunsense*, “Amanda” in *The Glass Menagerie*, “Dotty” in *Noises Off*, and has traveled the show *Erma Bombeck: At Wit’s End*. Directing credits numbering over 100 include *Big River*, *Young Frankenstein*, *Ring of Fire* and *The Fantasticks*. Kristy has traveled productions to the state, regional and national level over the last twelve years receiving recognitions along the way for top shows and for her work in direction, acting and design. Kristy has adjudicated high school and community festivals and is also the author of the stage adaptation of Doug Segrest’s novel, “A Storm Came Up.”



Kristy Meanor

### Brian Martin

Brian Martin is Chair and Professor of Theatre at Alabama State University where he is serving as the Director of Dramatic Guild, Advisor to the Student Government Association, Director and Coordinator of the Miss Alabama State University Coronation, Director of the ASU Convocation, Director of Elite Models, and Eclectic Dance Company. Martin has earned international recognition from the governments of several countries including Seoul, South Korea, South Africa, and Trinidad Tobago. He has leveraged much international collaboration and has served as a consultant to several Arts Institutions. Martin has contributed to and served on several Boards, Councils and Associations including the Alabama Council of the Arts as a grant reviewer and the Black Theatre Network as Treasurer. Many of Martin’s students have been afforded the opportunity to compete at the Kennedy Center, American College Theatre Festival in Washington D.C. Martin received the Meritorious Achievement Award for Excellence in Directing from the Kennedy Center for the double-billed production of “Da Kink in My Hair” by Trey Anthony, and for “Black Boys Who Have Considered Homicide When the Streets Were Too Much” by Keith Antar Mason.



Brian Martin

# davaine

LIGHTING AUDIO VIDEO THEATRICAL

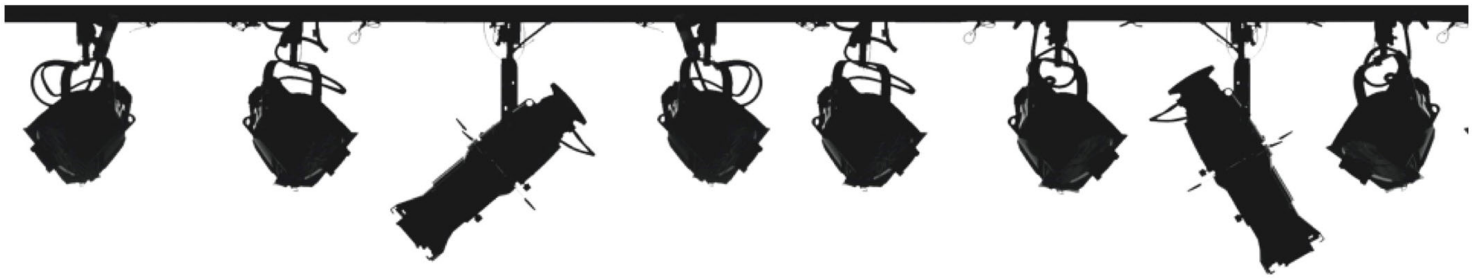

## Mississippi's Technical Theatre Experts



### SUPPLIES:

Gaffers Tape  
Color Filters  
Lamps & Clamps  
Gobos  
DMX Cable  
Fog Fluid  
Scenic Paint



### RENTALS:

Moving Lights  
LED Lighting  
Controllers  
Fog, Haze & FX  
Staging  
Rigging & Truss  
Video Screens



### SALES:

Stage Lighting  
Stage Curtains  
Dimming & Relays  
DMX Controls  
Rigging  
Flooring  
Audio & Video



### SERVICE:

Strand Systems  
ETC Systems  
Control & Networks  
Repairs  
Training  
Design  
Consulting

Davaine is Mississippi's authorized service center for ETC & Strand Dimming & Controls.



# ADJUDICATORS

## THEATRE FOR YOUTH

### Leslie Barker

Leslie Barker serves as the Arts-Based Community Development Director at the Mississippi Arts Commission. Through grants and programming, she also works with theatres and individual performing artists throughout the state. Barker received her MFA in Directing from the University of Memphis, and she was the 2021 winner of MTA's Adult Playwriting Competition. Barker has been a teaching artist, both in and outside of the classroom. She has served many years as the Director of Outreach and Education at Theatre Memphis and worked with young people and communities all over Memphis and she is an alum of the Lincoln Center Director's Lab. Some of Barker's favorite directing work has taken place at Theatre Memphis, The University of Memphis, Rhodes College and with Voices of the South, FEMMEMphis, and Chatterbox Audio Theatre.



*Leslie Barker*

### Paula Crockett Mabry

Paula has a Bachelor of Science in Speech and Theatre Education from the Mississippi University for Women. She also has a Master of Science in Theatre Education and Gifted Education and post graduate work in Theatre Education. She was Starkville High School's Teacher of Speech and Theatre 1986-2003 and is now retired. She has served as a theatre consultant, 2012-to present, and is an Instructor for Voice and Articulation and Introduction to Acting classes in the Mississippi State University Communication Department, 2015 to present. She was also Mississippi State University's Summer Scholars On Stage camp Stage director 1984-2007 and 2017. She was Starkville School District's Outstanding Teacher of the Year in 1990, 1991, 1997, and 1998; Educator of the Year in 1999; Third Congressional District Teacher of the Year in 2000; and Mississippi Teacher of the Year finalist in 2001. She was also selected to be a part of Starkville Chamber of Commerce's Education Hall of Fame in 2002 and was awarded the Mississippi Alliance in Arts Education Award in Theatre Arts, 2002. Mabry was awarded the Mississippi Theatre Association's "Outstanding Contributions to Theatre" Award in 2011; and was MTA's Community Theatre Chair 2015-2018; Secondary Theatre Best Director in 1992 and 1998; and Community Theatre Best Director in 2004 and 2010. Mabry has also served as a part of the Mississippi University for Women's Development Board 2015-2021 and has a MUW Theatre scholarship in her name.



*Paula Mabry*



# Break a leg Madison

Madison, we have never been more proud of you than we are now. We each love you SO much! May you always be a kind, loving, caring, and compassionate young woman, with a servant's heart, loving the Lord all the days of your life.

*Love,*

*Mom, Dad, Alyssa, and Bryson*

*Nana and Papa*

*Granny and Granddaddy*

*Uncle Matt, Aunt Katherine, Zeke, Finn, and Ava Lu*

*Uncle Michael and Miss Caitlin*

*Uncle Stephen, Aunt Alyssa, and Addie*



# ADJUDICATORS

## YOUTH INDIVIDUAL EVENTS

### PRELIMINARY JUDGES:

Alyssa Algee  
CC Allgood  
Aretta Baumgartner  
Allie Bennett  
Cindi Bullard  
Michael Dendy  
Ali Dinkins  
Lindsey Eubanks  
Andrew Fehrenbacher  
Christopher Flynn  
Dominique Frederick  
Taylor Galvin  
Erin Gill  
Rachel Glazer  
Keri Horn  
Neill Kelly  
Clay Kirkland  
Lexie Lang  
Tiffany McGehee  
Magda Mirelez  
PJ Padgett  
Tara Padgett  
Jennifer Patin  
Francine Reynolds

JoAnn Robinson  
Brodrick Ryans  
Elissa Sartwell  
Christian Scott  
Lacey Smith  
Gabe Smith  
David Sollish  
Drew Stark  
Derek Van Barham  
Jermaine Van Buren

### FINAL ROUND JUDGES:

Michael Barnett  
Jason Patrick Hudson  
Steve Kinkaid  
Lawson Marchetti  
Kristina Myers  
Mandy Kate Myers  
Ilka Roberts  
Chris Roebuck  
Amy Smith  
Carol Joy Sparkman  
Cynthia Stuart  
Bronwyn Teague  
Jake Yenish



## ADULT INDIVIDUAL EVENTS

Jake Yenish  
Leslie Barker  
Lee Crouse

Shout out

to all our Individual Events  
adjudicators!

We could not do this without you!



**davaine**

LIGHTING AUDIO VIDEO THEATRICAL

### Come see what we have to offer!

Davaine Lighting will have an interactive exhibit set up throughout the festival in the exhibit hall.

We'll be providing demonstrations of LED lighting technology and an opportunity for students and faculty to learn about their functional and creative uses for theatre and live events. We'll also have a display of stage curtains and a pop-up supply shop for common expendables like gaffers tape, lighting gels, tie line and other technical theatre accessories.

# PLAYWRITING COMMITTEE

Thank you to our talented Committee

## ADULT

### Matt Webb

Assistant clinical professor, Mississippi State University

### Sarah Wade

Theatre teacher at Armstrong Middle School

### Mark Dunn

Published playwright and novelist

## YOUTH

### Matt Webb

Assistant clinical professor, Mississippi State University

### Cayson Miles

Award winning playwright

### Mark Dunn

Published playwright and novelist



**Mississippi  
Presenters'  
Network**  
[presentmississippi.org](http://presentmississippi.org)

MSPN supports arts  
presenters through  
Advocacy, Professional  
Development, and  
collaborative projects.

Scan the QR code to  
nominate your  
favorite event to win  
a \$250 mini grant  
from MSPN



**Mississippi  
Alliance**  
for **arts**  
**Education**

Surprising Solutions: *Arts Education*

[www.msartsalliance.com](http://www.msartsalliance.com)





# MTA SCHOLARSHIP

## SUPPORT THE FUTURE

MTA awards one \$2000 scholarship to a deserving high-school senior who intends to pursue a degree in theatre (performance, technical, or design) at a Mississippi college or university. The award is presented during the MTA Festival.

Scholarship recipients are required to take theatre-related courses and maintain at least a 2.5 GPA taking a minimum of 12 hours per semester. These courses must be in a theatre-related program at a Mississippi college or university (this does not include extracurricular workshops or summer theatre camps). Scholarship students are required to be a part of the Dream Team for their first year of receiving the scholarship. For their remaining years, they will be given first choice of being a part of the Dream Team.

Those wishing to receive a scholarship for acting must register for and attend the auditions for colleges and universities. Those wishing to receive a scholarship for a technical-related major in theatre must register for and participate in the Tech Interview Process for colleges and universities. Both the audition and interview events typically take place the Thursday evening prior to the State Festival in January. Members of the scholarship committee will be there to observe both events.

More information on the MTA website, [www.mta-online.org](http://www.mta-online.org).



To continue supporting the future of theatre in Mississippi, we have set a goal to raise \$3,000 for the scholarship fund.

With the Giving Grid you can donate any amount from \$1 and \$1,000) or higher for this cause.

By donating to the Giving Grid you are helping to sponsor the MTA Scholarship Fund and Programming throughout the year.



*Let's get social*

#MTA2022

#MTAISBACK

#MSDoesGreatTheatre



@mississippitheatreassociation



@mstheatre



@mississippitheatre

**WIRELESS PASSWORD - dynamic**

# MTA SCHOLARSHIP

## SCHOLARSHIP RECIPIENTS

2021	Harley Armstrong	The University of Southern Mississippi
2020	Aysha Celestin	Mississippi University for Women
2019	Andrew O'Quinn	University of Mississippi
2018	Jonathan Landon Morrow	Pearl River Community College
2017	Renee Shield	Mississippi Gulf Coast Community College - Perkinston Campus
2016	Rachel Roan	University of Southern Mississippi
2011	Kristin Zumbro	University of Mississippi
2010	Logan Little	University of Mississippi
2009	Jessica Roberts	University of Southern Mississippi
2009	Maureen Hughes	Mississippi State University
2008	Jordan Randall	University of Southern Mississippi
2007	Chris Dunnels	University of Mississippi
2006	John Neill Kelly	University of Mississippi
2005	Krystal Sabol	William Carey College

Break legs, everyone!

# UPROAR



## THEATRE COMPANY

Uproar Theatre Company is Jackson's newest public theatre. Our mission is to inspire, nurture, challenge, amaze, educate and empower local artists and audiences in order to make the greater Jackson area a more conscious and compassionate community.

Learn more about Uproar at [www.uproartheatre.org](http://www.uproartheatre.org) or visit us on Facebook.

# RILEY CENTER FLOOR MAPS



## First Floor

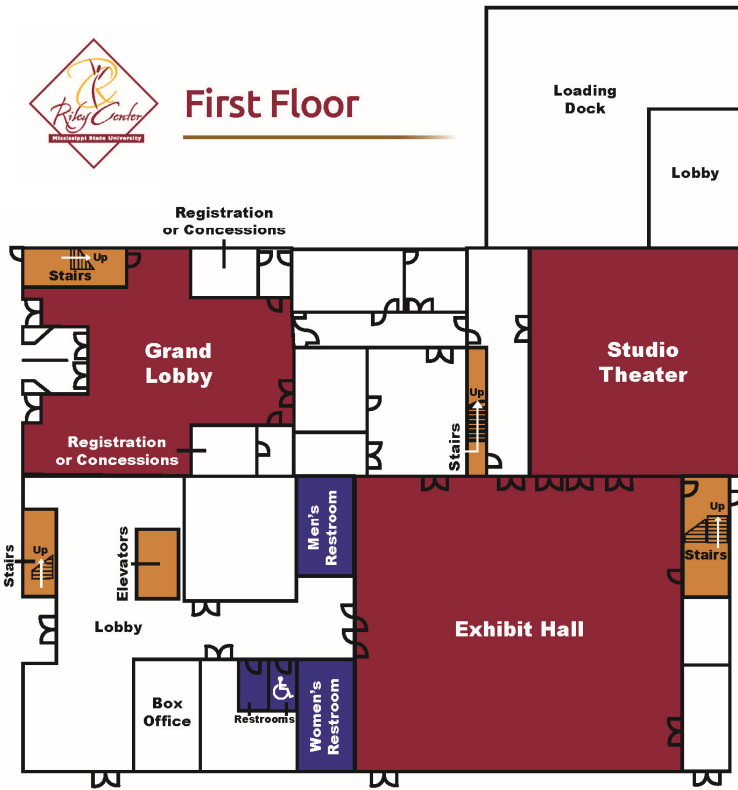

## Second Floor



## Third Floor

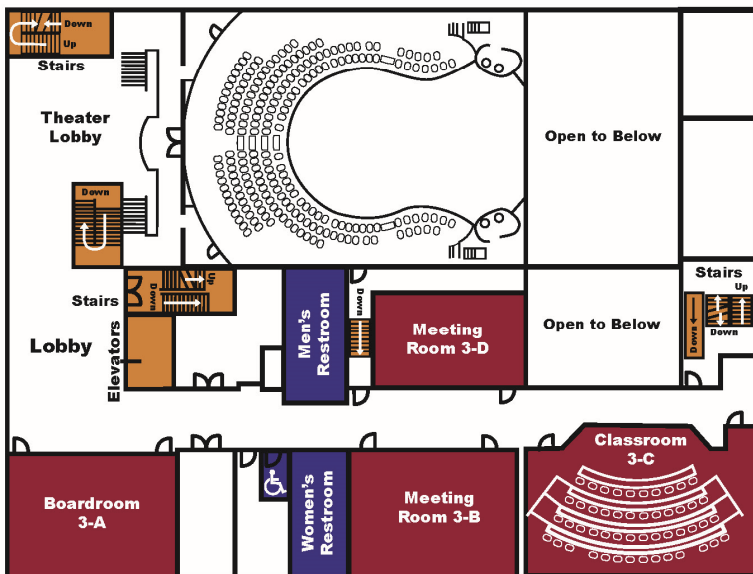

## Fourth Floor

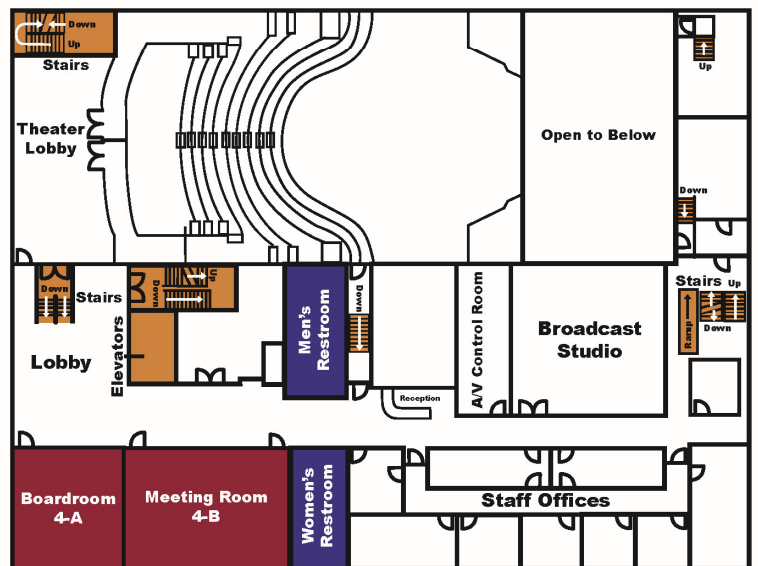



# PLAYWRITING CAST

## Adult Playwriting Competition Winner

### *Drinks on Me*

#### Cast

Raymond Pace as Sweets

Randy Ferino as Boogie

TaKirra Smith as Lola

Ashlee Silliman as Beadie Girl

Keith Allen Davis Jr. as Gary

Joshua Malcolm Jovon Davis as Simon

Anquanizia Hall as Narrator

## Youth Playwriting Competition Winner

*January 24, 1971*

#### Cast

Harrison Central High School



# Mississippi Arts+ Entertainment Experience <sup>SM</sup>

Mississippi Arts and Entertainment Experience

2155 Front St, Meridian, MS 39301

\$8.00 Entry Fee with Festival Badge

Anytime during the MTA Festival Weekend



Website



Facebook

## Your Only Limit is You!

Whether you are looking for an adjudicated competition, public performance opportunity, workshop or touring experience, we have got you covered! Let us plan an exciting trip that brings fun whether you are on or off the stage! We handle all the logistics of transporting your group!

## Where will your next performance take you?

*adventures start here*

[jordan@ourgrouptour.com](mailto:jordan@ourgrouptour.com)

(844) 286- 6227, ext. 1#

[kim@ourgrouptour.com](mailto:kim@ourgrouptour.com)

(844) 286- 6227, ext. 2#

# FOOD and SUCH

## Thursday, January 13

The Bully Shop: 8:00 AM - 10:00 PM

Chick-Fil-A and Pizza available 4:00 PM until sold out.

## Friday, January 14

The Bully Shop: 8:00 AM - 10:00 PM

Chick-Fil-A and Pizza available 4:00 PM until sold out.

## Saturday, January 15

The Bully Shop: 8:00 AM - 8:00 PM

Chick-Fil-A and Pizza available 4:00 PM until sold out.

## Lunch Pick Up

Pre-paid box lunches can be picked up outside of the Exhibit Hall.

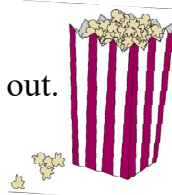

# ETIQUETTE

- Turn off (OFF, OFF) your cell phone and **any** electronic device that makes a noise or lights up.
- Be on time!
- Please do not talk during the performance.
- No photographs or video recordings. Period.
- Applaud. What actor doesn't like applause?
- If you need cough drops or candy, please unwrap them in advance!
- Be the kind of audience member YOU want to perform for!
- Re-read the first bullet point.



## BULLDOG SHOP MERIDIAN

### CHEESE

Edam • \$23 - Cheddar • \$16 - Jalapeño • \$16

### ICE CREAM

Individual Cup - \$1.64

vanilla, chocolate, strawberry, muscadine ripple, cookies & cream, chocolate almond and butter pecan

Half Gallon - \$7.50

vanilla, chocolate, strawberry, muscadine ripple, cookies & cream, chocolate almond, butter pecan, coffee and praline pecan

### GOURMET COFFEE

sold daily at \$1(S), \$1.50 (L) per cup or 1lb bag \$10.50

### GRAB-N-GO SELECTIONS

\$2.50 - \$3.50

Assorted Sandwiches and Wraps

\$2 - \$2.50

Biscuits & Bagels

sausage or chicken

Soft Drinks, Water, Energy Drinks, Juice  
Snacks, Candy, Chips, Cookies, Fruit

Hours:  
Monday - Friday  
8am - 5pm

   
@bulldogshopmeridian

2214 5th Street  
Meridian, MS 39301  
601-484-0200



## Menu



### Drinks

	Small	Large
Americano	\$2.00	\$2.50
Cappuccino	\$3.00	\$3.50
Latte	\$3.00	\$3.50
Special Latte*	\$4.00	\$4.50
Iced Coffee	\$2.50	\$3.00
Frappe	\$4.50	\$5.00
Hot Chocolate (Dark or White)	\$2.50	\$3.00
Smoothie	\$4.00	\$4.50
Drip Coffee	\$1.00	\$1.50
White Milk	\$2.00	
Chocolate Milk	\$2.50	
Extra Flavor	\$0.50	
Extra Shot Espresso	\$0.50	



**BULLDOG SHOP**  
MERIDIAN

# THANK YOU

to the Colleges and Universities  
participating in the audition process  
this weekend!

Belhaven College

Mississippi State University

Mississippi University for Women

The University of Mississippi

University of Mobile

University of South Alabama

University of Southern Mississippi

William Carey University

Theatre  
is back in the  
spotlight  
in Mississippi!

Starkville Community Theatre  
is a proud member of the  
Mississippi Theatre Association.



*Break a leg, everyone!*

# Congratulations

**We are so proud of our  
girls with all that you  
have each accomplished.**

**We love you.**

**Now, go break a leg!**

*With extraordinary love,  
Your Moms (and Luke!)*





# RECOGNIZING EXCELLENCE

## THE STEPHEN CUNETTO AWARD

The Stephen Cunetto Award is awarded by the Board of Directors to an individual who has added significantly to the successful operation of MTA through actions that are noteworthy for their positive image, regional recognition, long tenure, program establishment, and/or administrative service, rather than for their personal gain. (The Cowboy Maloney Award is now recognized as The Stephen Cunetto Award beginning in January 2016.)

2021	Pattye Archer	Starkville Community Theatre
2020	Dex Edwards	University of Mississippi
2018	Tom Hardy	Just Over the Rainbow
2016	Tom Booth	Tupelo Community Theatre
2015	William "Peppy" Biddy	Mississippi University for Women
2013	Obra Quave	William Carey University
2012	Wayne and Jo Durst	Mississippi State University
2011	Tonya Hays	WINGS Performing Arts
2006	Shannon Robert	William Carey College
2003	Ronnie Miller	Meridian Community College
2002	Jerry Bangham	
2001	Larry Mullican	University of Southern Mississippi
2000	Tim and Sonya Bixler	Delta Center Stage
1998	Hoagan Bramlett	
1997	R. B. Hill	University of Southern Mississippi
1994	Blaine Quarnstrom	University of Southern Mississippi
1989	Dominic J. Cunetto	Mississippi State University
1988	Kathryn Lewis	
1987	Denise Halbach	
1986	Charles Lembright	
1985	Ruth Liveakos	
1984	Margaret and Tom Sawyer	
1983	Dick Strahan	
1981	The Sheffields	

## THE OUTSTANDING CONTRIBUTION TO THEATRE IN MISSISSIPPI AWARD

The Outstanding Contribution to Theatre in Mississippi Award was established to honor outstanding members of our organization. This award does not have to be given annually. The Board of Directors holds the right to only give out this award if there is an outstanding nominee. An award can be presented in each major division during any given year. The divisions are Member, Secondary, Community Theatre, Theatre for Youth, College & University, Principals, and Community Officials. The nomination of members should be based upon their service to the organization and field. We hope that this award will help shine a light on our many supporters and workers who work tirelessly to benefit the arts and MTA.

2021	Mike Calnam	Vicksburg Theatre Guild (Community Theatre)
2021	Rafe O'Neal	Mississippi Gulf Coast (Community Official)
2021	Chris Permenter	Ocean Springs High School (Secondary)
2020	Lori Parkman Nail	Northwest Rankin High School (Administrator)
2019	Dr. Howard Savage, Jr	Quitman High School (Administrator)
2019	Lavonne Bruckner	Actors Playhouse (Community Theatre)
2019	Ryan Pierini	MGCCC JD Campus (College / University)
2018	Joseph Williams	WINGS Performing Arts (Community Theatre)
2017	Steven Nabors	Meridian Community College (College / University)
2016	Sandra Camphor	Ocean Springs High School (Secondary)
2015	Chris Wooten	Just Over the Rainbow Theatre (Community Theatre)

BREAK A LEG

# NORTHWEST RANKIN HIGH SCHOOL THEATRE

SECONDARY FESTIVAL &  
THEATRE FOR YOUTH &  
INDIVIDUAL EVENTS &  
COLLEGE & SCHOLARSHIP AUDITIONS

## PRODUCTIONS & TIMES:

Secondary Festival: ICARUS

FRIDAY, JANUARY 14 @ 4:10 PM

Theatre for Youth: MONSTER CAMP

SATURDAY, JANUARY 15 @ 3:45 PM

Find us online at [nwrthespians.com](http://nwrthespians.com)  
@nwrthespians on social media





  
**THEATRE  
& FILM**  
AT  
THE UNIVERSITY OF  
MISSISSIPPI

**BFA EMPHASES IN:**

**ACTING FOR  
STAGE & SCREEN  
DESIGN/THEATRE  
PRODUCTION**

**BFA IN FILM PRODUCTION  
AND  
BA IN THEATRE ARTS**

